

Specifications

FKS PrintBind KB-4000 PUR

Book size:	120 x 120 mm (min.) 420 x 360 mm (max.)
Spine thickness:	2 mm (min.) 50 mm (max.)
Cover size:	120 x 240 mm (min.) 425 x 780 mm (max.)
Max. Cover weight:	400 g/m <sup>2</sup> (pre-creased)
Max. Books per hour:	200 cycles/hour (Effective Output depending on user and material)
Glue pre-heating time:	Approximately 30 minutes
Binding system:	PUR Glue (spine gluing) Hotmelt (side gluing)
Glue application system:	1 Nozzle (Closed, volumetric System) 2 Active Hotmelt Side Gluing Discs

Features:	Automatic Pre-clamp Unit Touchscreen Display Batch Counter Total Counter Dust Exhauster Programmable Press Time Standby Milling, Notching and Micro-Notching Book and Spare-Cover Shelf
Compressed air supply:	Compressor or central air supply (120 l/Min., 8 bar)*
Options:	Compressor
Power supply:	400 V, 50 Hz, 16 A, 4,6 kW (max.)
Dimensions (L x W x H):	2.010 x 975 x 1.300 mm
Weight:	380 kg

\* Compressed air must be oil and water free.  
Failure to observe this can cause a damage to the machine.

Duplo®  
from print to documents

FKS PrintBind KB-4000 PUR

ACCURATE AND SECURE PUR BINDING ON-DEMAND

Cycling speed - up to 200 books per hour  
PUR slot nozzle application system  
Professional side gluing application

Photo Albums · Directories · Instruction Manuals  
Catalogues · Telephone Directories · Paperbacks



Duplo International Limited  
Automated Precision House  
Hamm Moor Lane  
Addlestone  
Surrey KT15 2SD

Tel +44(0) 1932 263 900 - Fax +44(0) 1932 263 901  
info@duplointernational.com  
www.duplointernational.com

Duplo is a trade mark of the Duplo Corporation.  
Duplo has a policy of continuous improvement  
and reserves the right to amend the above specification  
without prior notice  
  
Production rates are based on optimal operating conditions  
and may vary depending on stock and environmental  
conditions. As part of our continuous product improvement  
program, specifications are subject to change without  
notice.



Ref: KB-4000PUR-02/12



The automated FKS PrintBind KB-4000 PUR raises the benchmark in perfect binding through its high productivity and cost efficiency. The compact PUR binder is the perfect solution for on-demand, high quality book making.

## Closed System with Dry Air Injection

The combination of airproof PUR tank and dry air injection offer considerable advantages compared with open tank systems: There is no need for periodic replenishment of the glue, complex cleaning or protection of the glue tank. When dry air is pumped into the unit, the life of the glue is prolonged, this provides significant savings on time and money.

The self-closing PUR nozzle prevents any reaction until the glue is applied to the spine of the book. Many hours of labour can be saved each week thanks to the automated cleaning feature. This usually takes less than 10 minutes to complete, making the machine very easy to maintain.



### Integrated Controls

Place the book block into the clamp and start producing books. Operation starts when pressing both Start buttons at the same time. The integrated controls ensure high precision at any time avoiding any kind of spoilage, from the first book to the last.

## PUR and EVA

The FKS PrintBind KB-4000 PUR works with a unique closed PUR application system. The volumetric slot nozzle ensures that PUR glue is accurately applied on the spine at any time. Easy and safe replenishment of PUR glue can be done in pellet or block form.

For even better adhesion and faster processing of books, the KB-4000 PUR provides active EVA hotmelt side gluing.

### Benefits of PUR melt:

- Strong adhesive bind
- Provides an extremely strong bind on all coated and digital printed papers
- Temperature resistant
- Very good resistance to aging
- Perfect long-term use properties
- Optimal lay flat quality

### Benefits of EVA hotmelt:

- Easy to use
- Very short setting time
- Provides fast finishing



### Touch Screen Display

One of the KB-4000 PUR key attributes is its easy-to-use touch screen. This includes the complete set-up of the machine, including all functional parameters. Even nipping time and nipping pressure can be adjusted.



### Heavy Duty Milling and Notching

The heavy-duty milling and notching tool ensures that an accurate and flat spine preparation is provided prior to gluing.



### High Productivity

The closed PUR application system offers various advantages compared to open systems, especially with regards to cost and productivity as waste and down times are minimal. Furthermore the closed PUR System does not need any air extraction, due to its minimal emissions.

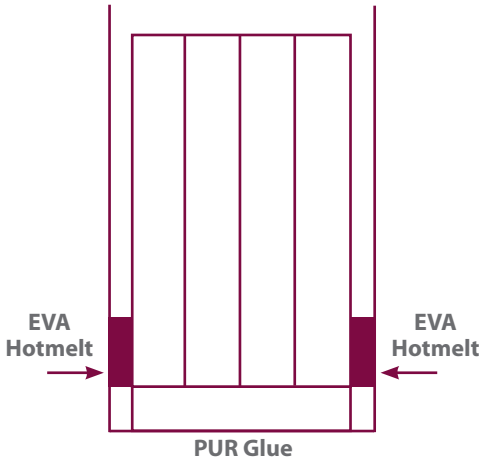

### Workflow for FKS Printbind KB-4000 PUR

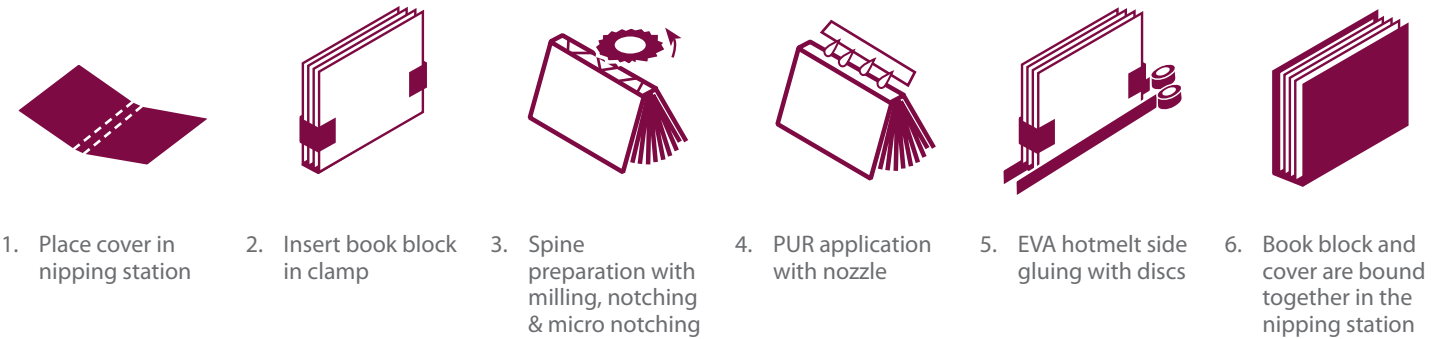

PUR nozzle

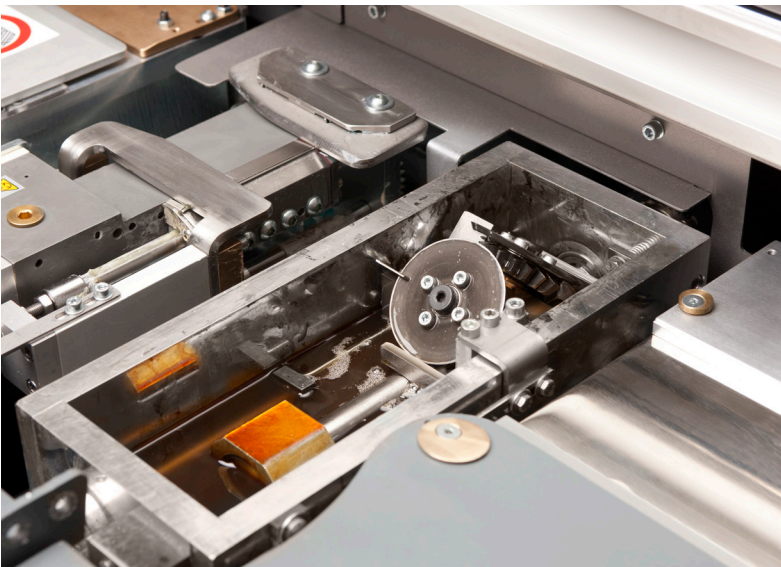

EVA side gluing tank

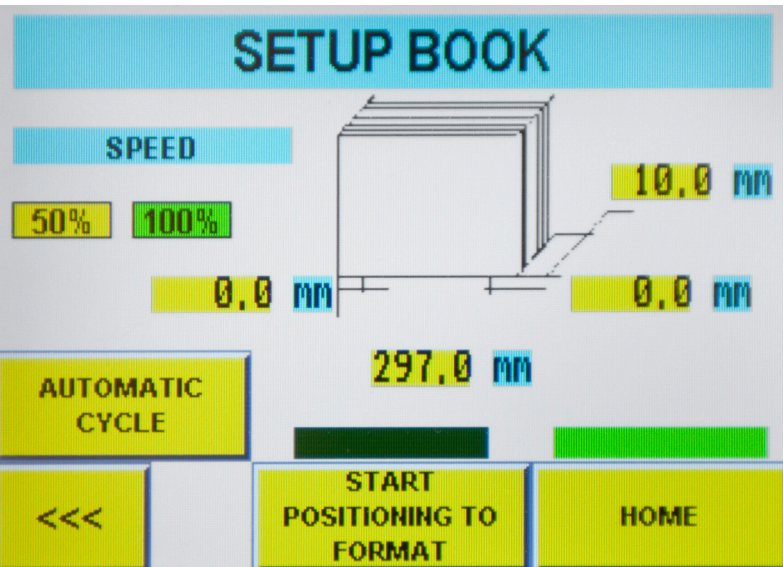

Touch Screen display



Built-in PUR tank and melter